

isofast™ Plates

Stacked plates for isofast™ system

Stacked insulation and membrane plates used with the isofast™ fastening system

- "The fastest way to install roofing fasteners!"
- Belted fasteners and isofast plates increase productivity and are ergonomically correct, allowing the contractor to install the roof assembly in an upright position when using the IF160 installation tool.

- Displaces labor costs
- Reduces workman's' compensation claims as they relate to injuries incurred while installing fasteners.
- Reduces installation costs up to 50%.



Application

IF-2.375-AT Membrane Plate

- Use with:
- #15 Belted Fasteners

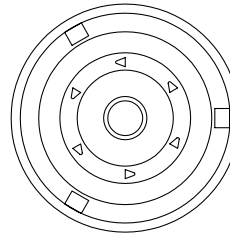
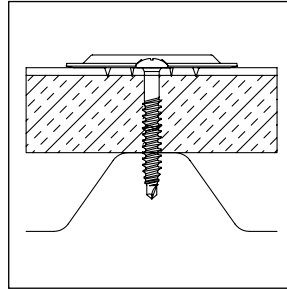

OD: 2 3/8" Round
ID: .265"
Thickness: .042"
Finish: AZ50 Galvalume®

IF-L-70 x 70 Insulation Plate

- Use with:
- #12 Belted Fasteners
 - #15 Belted Fasteners

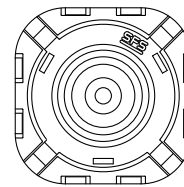
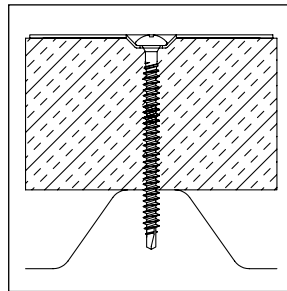

OD: 2-3/4" x 2-3/4" Square
ID: .257"
Thickness: .019"
Finish: AZ50 Galvalume

IF/IG-C 82x40 Membrane Plate

- Use with:
- #12 Belted Fasteners
 - #15 Belted Fasteners

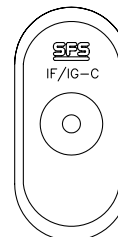
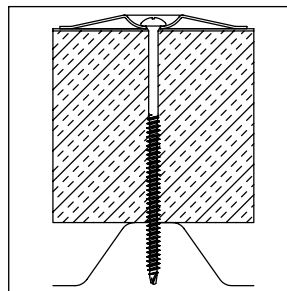

OD: 3-1/4" x 1-1/2" Oblong
ID: .220"
Thickness: .042"
Finish: AZ50 Galvalume

Notes

Dimensions are nominal inches unless noted.

Continued on following page

Stacked plates for IF-160 system

Stacked insulation and membrane plates
used with the IF-160 fastening system

isofast™ Plates

Selection

| Description | Part No. | Carton Wt. (lbs) | Carton Qty. | Skid Qty. |
|------------------------|----------|------------------|-------------|-----------|
| 2-3/8" Round | M7680 | 27 | 500 | 24,000 |
| 2-3/4" Square | M7710 | 29 | 750 | 40,500 |
| 3-1/4" x 1-1/2" Oblong | M7700 | 41 | 750 | 22,500 |

Approvals

isofast fasteners and plates are FM approved for insulation and roof cover attachment. Refer to FM approval guide and its supplements for current approved fastening spacings.

Installation

isofast plates are designed to be used with isofast fasteners and the IF160 Installation tool.
Use in applications approved by the roofing system manufacturer.

Options

