

#14

#3 Phillips drive, 10 tpi, drill point  
For insulation and membrane attachment to wood, steel, and structural concrete roof decks

- Can be pre-assembled to plastic Dekflat plate for insulation attachment and to seam plates for roof cover attachment.
- 10 threads per inch for ease of installation in concrete roof decks.
- Low profile truss head can be used for clip attachment in applications where head height is important.

- Deep #3 recess provides for ultimate bit engagement.
- The Dekfast reduced drill point provides for ultimate pull-out values by producing a minimum opening. Thread engagement is superior as compared to standard drill points.
- Standard gray e-coat coating provides compatibility with white, galvanized or gray deck undersides.



Application

#14 Dekfast Fasteners  
Insulation board to roof deck

Materials:

- Steel thickness from 22 ga (.028 in.) through 18 ga (.045 in.); Min penetration: 3/4"
- Plywood: Min thickness: 3/4" FR treated; min through penetration: 1/4"
- Wood 2x (1-1/2" thick); Min penetration: 1"
- Structural concrete: Min penetration: 1"

Use with:

- Dekfast 2-7/8" hex plates
- Dekfast 3" round plastic Dekflat plates
- Other attachment elements approved by the roofing system manufacturer for use with its products

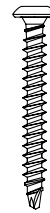
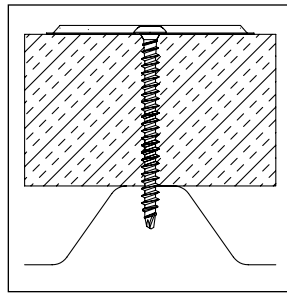

Head: #3 Phillips  
Head Height: .118" max  
Head Dia: .448" max  
Thread Major Dia: .238"  
Shank Dia: .180"

**Strength (lbs ult.):**

Tensile: 3600  
Torsional: 110 in-lbs min  
Shear: 2630

**Pull-out (lbs avg.):**

22 ga: 540  
20 ga: 630  
18 ga: 900  
4000 psi concrete (1" penetration): 850  
3/4" plywood (through penetration): 590  
2x dimensional lumber (1" penetration): 605

Notes

Dimensions are nominal inches unless noted. Steel roof decks include all FM-approved 18-20-22 ga. FM-approved wood decks include 3/4" FR plywood and 2x dimensional lumber. Structural concrete to be predrilled with standard 3/16" carbide bit to minimum 1/2" deeper than fastener penetration.

Selection

Length	Part No.			Carton Wt. (lbs)	Carton Qty.	Skid Qty.
	Phillips Head #14-10	Steel	Wood			
1-1/4"	A7210-995B	Up to 1/2"	Up to 1/4"	12	1,000	60,000
2"	A7216-995B	Up to 1-1/4"	Up to 1-1/4"	19	1,000	60,000
3"	A7224-995B	Up to 2-1/4"	Up to 2"	24	1,000	60,000
4"	A7232-995B	1-1/4" to 3-1/4"	1-1/4" to 3"	30	1,000	60,000
5"	A7240-995B	1-1/4" to 4-1/4"	1-1/4" to 4"	45	1,000	40,000
6"	A7248-995B	2-1/4" to 5-1/4"	2-1/4" to 5"	46	1,000	40,000
7"	A7256-995B	3-1/4" to 6-1/4"	3-1/4" to 6"	28	500	30,000
8"	A7264-995B	4-1/4" to 7-1/4"	4-1/4" to 7"	31	500	30,000
9"	A7272-995B	5-1/4" to 8-1/4"	5-1/4" to 8"	34	500	20,000
10"	A7280-995B	6-1/4" to 9-1/4"	6-1/4" to 9"	38	500	20,000
11"	A7288-995B	7-1/4" to 10-1/4"	7-1/4" to 10"	41	500	20,000
12"	A7296-995B	8-1/4" to 11-1/4"	8-1/4" to 11"	45	500	20,000

Approvals

Dekfast fasteners are Factory Mutual approved for attachment of insulation board and/or roof cover to roof deck. Refer to FM Approval Guide and Supplements for current FM approved insulation fastening patterns. #14 fasteners exceed Factory Mutual corrosion-resistance Standard 4470.

Installation

Tools: 2000–2500 rpm screw guns and #3 hardened Phillips bit. For structural concrete, 3/16" carbide bit and 1500 rpm max screw guns, or hammerdrills in the hammer mode.

Options

