

	<b>Section /Product Name</b>	<b>Product Description</b>	<b>Usage</b>
<b>1</b>	<b>FASTENERS</b> <ul style="list-style-type: none"> <li>• #12</li> <li>• #12 Hex Head</li> <li>• #14</li> <li>• #15</li> <li>• K-Fast™</li> </ul>	#3 Phillips drive, 13 tpi, drill point 1/4" hex drive, 13 tpi, drill point #3 Phillips drive, 10 tpi, drill point  #3 Phillips drive, 13 tpi, drill point  #3 Phillips drive, 13 tpi, drill point	<ul style="list-style-type: none"> <li>• For insulation attachment to wood and steel roof decks: FM and Dade Co. Approved</li> <li>• For insulation and membrane attachment to wood, steel and structural concrete roof decks: FM and Dade Co. Approved</li> <li>• For insulation and membrane attachment to wood, steel and structural concrete roof decks: FM and Dade Co. Approved</li> <li>• For membrane attachment to wood and steel roof deck: FM and Dade Co. Approved</li> </ul>
<b>2</b>	<b>STRESS PLATES</b> <ul style="list-style-type: none"> <li>• Insulation Plates</li> <li>• Membrane Plates</li> <li>• isofast™ Plates</li> </ul>	2-7/8" hex plate 3" round assemblies 2-3/8" round, 2" round, 3-5/8" round  2-3/4" square, 2-3/8" round	<ul style="list-style-type: none"> <li>• For insulation using Dekfast #12, #12 Hex, #14, #15, Dekspike™, Deklite™, and T.P.R.: FM and Dade Co. Approved</li> <li>• For membrane using #14, #15, K-Fast, Dekspike, Deklite, and T.P.R.: FM and Dade Co. Approved</li> <li>• Stacked insulation and membrane plates used with IF 160 system: FM and Dade Co. Approved</li> </ul>
<b>3</b>	<b>ASSEMBLIES</b> <ul style="list-style-type: none"> <li>• Insulation Assemblies</li> <li>• Membrane Assemblies</li> </ul>	#12, #14 & #15 assembled to metal and plastic insulation plates #14 & #15 assembled to metal and nylon membrane plates	<ul style="list-style-type: none"> <li>• For insulation attachment using pre-assembled #12, #14 and #15 fasteners and plates</li> <li>• For membrane attachment using pre-assembled #14 and #15 fasteners and plates</li> </ul>
<b>4</b>	<b>BELTED SYSTEMS</b> <ul style="list-style-type: none"> <li>• #12 Belted</li> <li>• #15 Belted</li> <li>• isofast Plates</li> </ul>	#12 Dekfast insulation attachment #15 Dekfast seam attachment Stacked plates for isofast System	<ul style="list-style-type: none"> <li>• For insulation attachment using #12 Dekfast with #3 Phillips drive collated for IF 160 system</li> <li>• For membrane attachment using #15 Dekfast with #3 Phillips drive collated for IF 160 system</li> <li>• Stacked insulation and membrane plates used with IF 160 fastening system</li> </ul>
<b>5</b>	<b>LOG HOME FASTENERS</b> <ul style="list-style-type: none"> <li>• Log Screw Max</li> <li>• Log Screw</li> </ul>	#19 hex head, winged, rico point #15 hex head, winged, rico point	<ul style="list-style-type: none"> <li>• For heavy-duty log tie in</li> <li>• For construction of log homes</li> </ul>
<b>6</b>	<b>NAIL BOARD FASTENERS</b> <ul style="list-style-type: none"> <li>• Insulation Panel Fasteners</li> </ul>	#14 #3 square drive, rico point	<ul style="list-style-type: none"> <li>• For use in vented and/or composite nailboard applications</li> </ul>
<b>7</b>	<b>SPECIALTY PRODUCTS</b> <ul style="list-style-type: none"> <li>• Deklite™</li> <li>• Dekspike™</li> <li>• Stainless Dekfast</li> <li>• Purlin Fastener</li> <li>• T.P.R. Peel Rivet</li> <li>• Teleskop</li> <li>• Insulated Panel Fastener</li> <li>• Drill Bits</li> <li>• ZAC® Anchors</li> <li>• Zinc Nailins</li> </ul>	Nylon reinforced fiberglass auger 1/4" mushroom head #14, 13 tpi, drill point #12 #3 square drive, drill point Two piece aluminum magnesium alloy fastener Non-thermal bridging-fastening system #14 #3 square drive, rico point 3/16", 7/32", 1/4" 3/8" AF termination fastener Termination fastener	<ul style="list-style-type: none"> <li>• For lightweight roof decks, concrete, tectum, and gypsum, for insulation and membrane: FM and Dade Co. Approved</li> <li>• For insulation and membrane attachment on structural concrete roof decks: FM and Dade Co. Approved</li> <li>• For insulation and membrane attachment roof covers in a corrosive environment</li> <li>• For retro-fit roofing systems to penetrate heavy-gauge purlin</li> <li>• For insulation and membrane attachment in problematic roof decks</li> <li>• For insulation and membrane attachment in non-thermal bridging applications</li> <li>• Insulated panel fasteners</li> <li>• Carbide tipped bits for structural concrete</li> <li>• For fastening termination bar at wall terminations</li> <li>• For fastening termination bar at wall terminations</li> </ul>
<b>8</b>	<b>TERMINATION PRODUCTS</b> <ul style="list-style-type: none"> <li>• Termination and Batten Bars</li> </ul>	.075", .100", .125" thick, 6", 8", 12" OC	<ul style="list-style-type: none"> <li>• For wall termination applications</li> </ul>
<b>9</b>	<b>INSTALLATION TOOLS</b> <ul style="list-style-type: none"> <li>• Stealth</li> <li>• isofast 160</li> </ul>	#10, #20, shorty Belted #12's and #15's	<ul style="list-style-type: none"> <li>• For use with pre-assembled products</li> <li>• Automated belted product for attachment of insulation and membrane roof covers</li> </ul>
<b>10</b>	<b>COATINGS</b> <ul style="list-style-type: none"> <li>• Senti™ XP Coating</li> </ul>	Grey, blue and black coatings	<ul style="list-style-type: none"> <li>• For ultimate corrosion resistance</li> </ul>

Applications

Views

1

- 18, 20, 22 gage metal 2x dimensional lumber
- 18, 20, 22 gage metal deck, plywood and 2x dimensional lumber, structural concrete, concrete plank, hollow core concrete plank
- 18, 20, 22 gage metal deck, plywood and 2x dimensional lumber, structural concrete, concrete plank, hollow core concrete plank
- 18, 20, 22, 24, 26 gage metal deck, plywood and 2x dimensional lumber

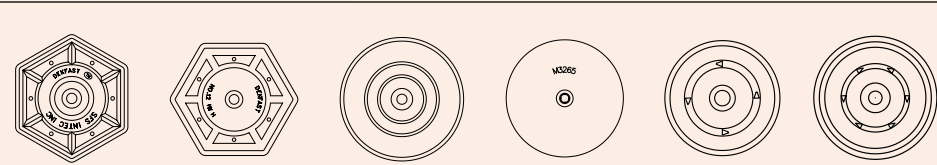
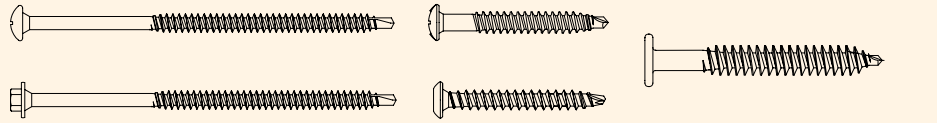

2

- FM approved insulation attachment
- Mechanical attachment for single ply membrane per manufacturer's requirements
- FM approved insulation attachment
- Mechanical attachment for single ply membrane per manufacturer's requirements

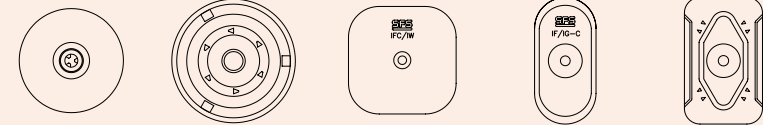

3

- 18, 20, 22 gage metal deck, plywood and 2x dimensional lumber
- Mechanical attachment for single ply membrane per manufacturer's requirements

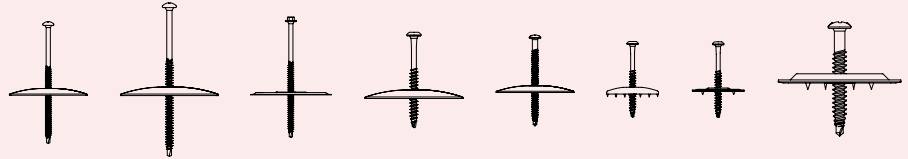

4

- 18, 20, 22 gage metal deck, plywood and 2x dimensional lumber
- Mechanical attachment for single ply membrane per manufacturer's requirements

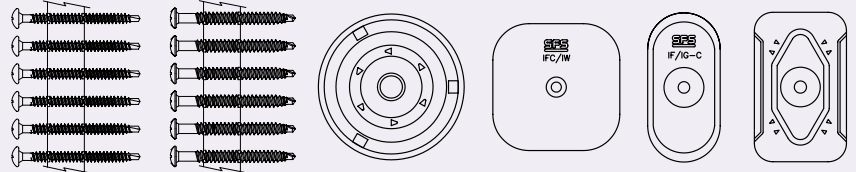

5

- For use in the construction of log homes
- For use in the construction of log homes



6

- 18, 20, 22 gage metal deck, plywood and 2x dimensional lumber

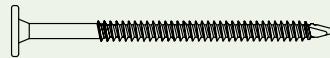

7

- Lightweight insulating concrete, poured gypsum, gypsum plank, tectum
- Structural concrete
- Stainless steel specialty decking
- Up to 1/4" purlin steel
- Fiberglass and light gage steel decking and all problematic deck types
- All listed deck types with thermal bridging concerns 18, 20, 22 gage metal deck.
- 18, 20, 22 gage metal deck, plywood and 2x dimensional lumber
- Structural concrete
- Termination attachment
- Termination attachment

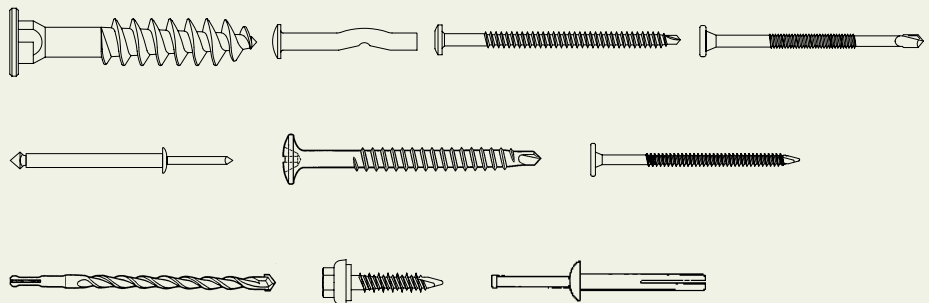

8

- 18, 20, 22 gauge metal decks and roof wall terminations

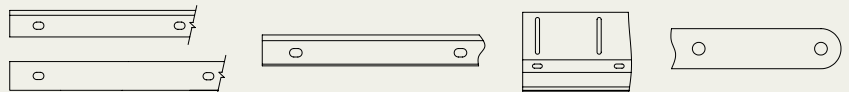

9

- Tools can be used on all listed applications to ensure uniform installation depth on roofs

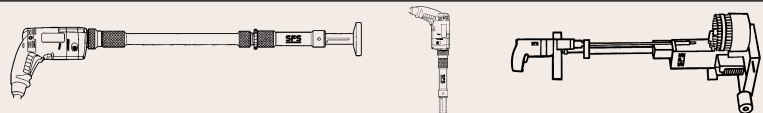

10