

**Elegantly smooth appearance,
but secretly very strong!
With the SFS blind fastener TU-S.**



Secure and easy blind attachment of HPL panels: The SFS TU-S fastening system

Easy attachment

The TU-S blind fastener from SFS is superior to previous approaches to the attachment of HPL cladding panels with regards installation and long-term security. TU-S fasteners are used to attach brackets on the back of HPL cladding panels and are recommended by leading international panel manufacturers. Panels 8 to 13 mm thick can be attached. Installation can be performed quickly and securely by one person, without using special tools. Installation time can also be reduced by up to 30% compared with conventional blind attachments.

The TU-S blind fastener can be removed once if required.

Optimum security

Despite easy and extremely time-saving installation, the TU-S is a secure solution. The fastener cannot be overdriven during installation. Due to its radial expansion when the mandrel is removed, the partially cut thread becomes wedged in the panel material, generating very high pullout values. Spontaneous slackening due to expansion or vibration is impossible. The sleeve is made of austenitic stainless steel (material DIN 1.4401, grade 316).

Our technical advisers will be pleased to provide you with detailed information. Just telephone us.

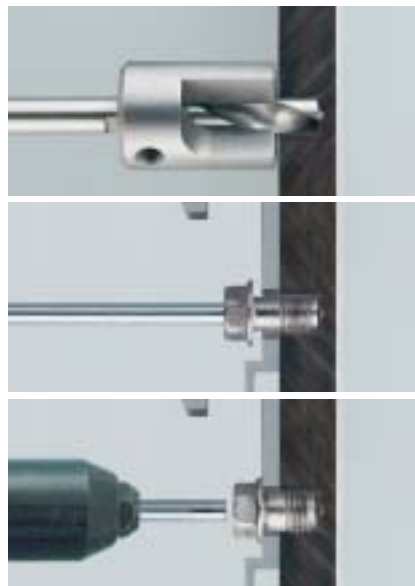

Pilot drilling in the HPL panel with the 6 mm dia. HSS blind hole drill with depth stop (hole diameter 5,95 – 6,1 mm). Minimum residual thickness 1,5 mm.

Position the pre-drilled bracket over the hole in the panel and push through the TU-S blind fastener.

Remove the mandrel completely with the riveting tool (e.g. SFS TPR50 or PowerBird®, use nosepiece 17/36 or 17/40).

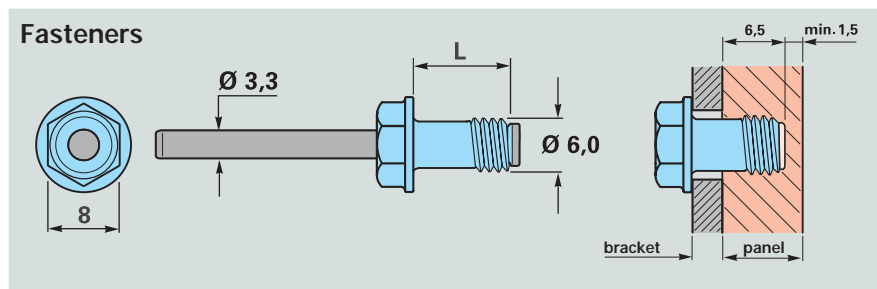

Order code

Type	Material S = stainless	Ø (mm)	L (mm)	panel (mm)	bracket (mm)
TU- S-		6×	9	8 10 – 13	2,5 – 3,5 0,5 – 3,5
TU- S-		6×	11	8 10 13	4,5 – 5,5 2,5 – 5,5 0,5 – 5,5
TU- S-		6×	13	10 13	4,5 – 7,5 2,5 – 7,5

Tools

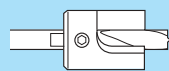

HSS blind hole drill, 6 mm dia. with depth stop

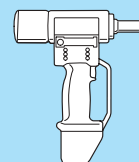

PowerBird® setting tool

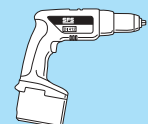

SFS DI412 battery-powered screwgun