

isofast® Plates

2-3/4" square, 2-3/8" round  
Stacked insulation and membrane plates  
used with the isofast® fastening system

- "The fastest way to install roofing fasteners!"
- Belted fasteners and isofast plates increase productivity and are ergonomically correct, allowing the contractor to install the roof assembly in an upright position when using the IF 160 or IF 240 installation tools.

- Displaces labor costs.
- Reduces workman's compensation claims as they relate to injuries incurred while installing fasteners.
- Reduces installation costs up to 50%.



Application

**IF-2.375-AT  
Membrane Plate**

- Use with:
- #15 Belted Fasteners

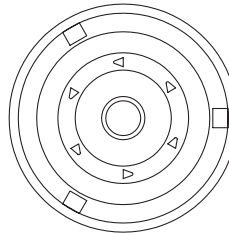
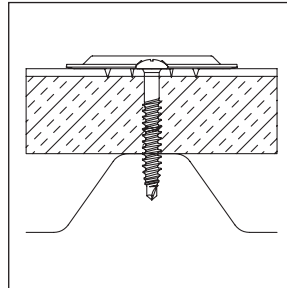

OD: 2 3/8" Round  
ID: .265"  
Thickness: .042"  
Finish: AZ50 Galvalume®

**IF-L-70 x 70  
Insulation Plate**

- Use with:
- #12 Belted Fasteners
  - #15 Belted Fasteners

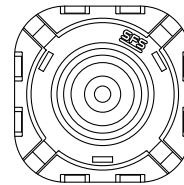
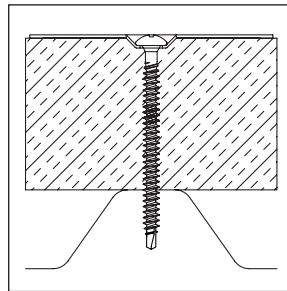

OD: 2-3/4" x 2-3/4" Square  
ID: .257"  
Thickness: .019"  
Finish: AZ50 Galvalume

**IF/IG-C 82x40  
Membrane Plate**

- Use with:
- #12 Belted Fasteners
  - #15 Belted Fasteners

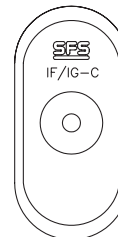
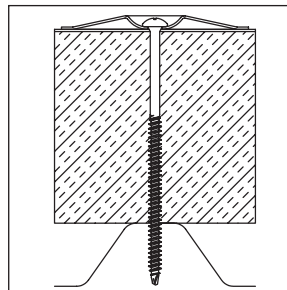

OD: 3-1/4" x 1-1/2" Oblong  
ID: .220"  
Thickness: .042"  
Finish: AZ50 Galvalume

Notes

Dimensions are nominal inches unless noted.

Continued on following page

isofast® Plates

2-3/4" square, 2-3/8" round  
 Stacked insulation and membrane plates  
 used with the isofast® fastening system

Selection

Description	Part No.	Carton Wt. (lbs)	Carton Qty.	Skid Qty.
2-3/8" Round	M7680-TPL	41	500	31,500
2-3/4" Square	M7710-TPL	41	750	40,500
3-1/4" x 1-1/2" Oblong	M7700-TPL	37	750	18,250

Approvals

isofast fasteners and plates are FM approved for insulation and roof cover attachment. Refer to FM approval guide and its supplements for current approved fastening spacings.

Installation

isofast plates are designed to be used with isofast fasteners and the IF 160 or IF 240 installation tools. Use in applications approved by the roofing system manufacturer.

Options

